



# A TOUCH OF COLOUR A SPLASH OF BRILLIANCE



Print • Copy • Scan • Fax

Business *can* be simple



# MADE FOR COLOUR WORK WITH COLOUR

Designed for your compact, functional office

## Highlights

- Up to 25/25 pages per minute (A4) in colour or monochrome
- 1GB RAM
- Automatic Document Feeder
- UFR II Printing (Optional: PCL/PS)
- Mobile Connectivity
- Colour Push Scan (Email, Network folders)
- Extensive Scanned File Formats (PDF, Compact PDF, Searchable PDF, JPEG and TIFF)
- Standard Paper Capacity\* -  
Bypass: 100 sheets | Cassette: 550 sheets

\*Based on 80g/m<sup>2</sup> paper

## EXCELLENT USABILITY

### INTUITIVE COLOUR TOUCH SCREEN

This intuitive tiltable 3.5" QVGA colour touch screen makes operation effortless through direct touch and swipe gestures while high operability is maintained.

## OUTSTANDING PRODUCTIVITY

### QUICK RECOVERY FROM SLEEP MODE

Recovering from sleep mode is as fast and easy as entering into sleep mode. To get your device up and running again from sleep mode, simply touch the screen or any buttons on the control panel.

### CUSTOMISING FAVORITE SETTINGS

Improve productivity by registering frequently used settings into shortcut buttons on your Home screen. You can easily add on, delete, re-position or even rename these buttons to your convenience. Rest assured that your shortcuts will remain in memory even after power-off.

## Extraordinary business value within your reach

With productivity boosting features like printing speed of up to 25ppm in colour and monochrome, network sharing, colour scanning, mobile connectivity, secure printing, additional security features and fax management with hassle-free device maintenance, the imageRUNNER C1325 adds a touch of brilliance to your everyday business workflow. Now, you can deliver more value to your customers while keeping costs low.



## PRODUCTIVITY

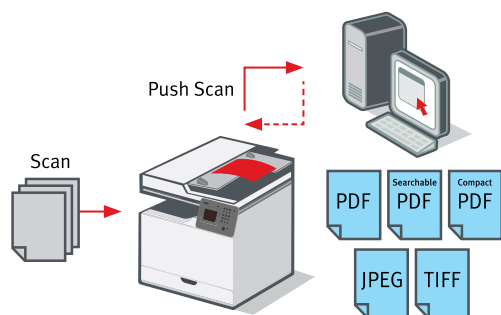

### CONVENIENT COLOUR SCANNING, EXTENSIVE FILE FORMATS

Digitise your originals conveniently using scan to email or network folder without accessing your PC into various format which include PDF, Compact PDF, Searchable PDF, JPEG and TIFF.

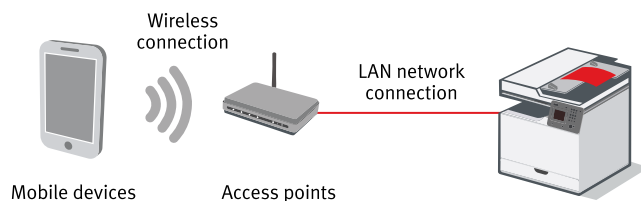

### MOBILE CONNECTIVITY

Experience simple mobile print functionality with features to help mobile device users print jobs from their devices. It supports a wide variety of file formats including image, photo, PDF files and web pages.

Mobile users can also use the Canon Mobile Scanning for Business to scan and save data on their mobile devices, send it as e-mail attachments to themselves.

With Canon Mobile Solutions\*, you can now scan, manage, and print photos, web pages, documents, and more from iOS or Android™ terminal, all with the imageRUNNER C1325.

\*Canon Mobile Printing and Canon Mobile Scanning apps may be downloaded on iOS or Android mobile devices.

### ID Card Copy

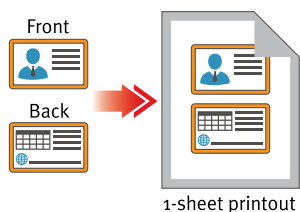

### ID CARD COPY

Copying ID card is simpler than ever before! With a one-time operation, you can copy both sides of the ID card onto the same page of a paper without the need to manually reload the paper.

### SEARCH DOCUMENTS EFFORTLESSLY

Scan your documents in Searchable PDF format and effortlessly perform text searches on document contents. To enjoy greater productivity, you can now easily copy and paste everything to other file formats.



## PRODUCTIVITY

### SCAN TO USB, PRINT FROM USB

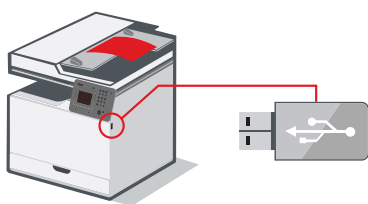

Scan documents directly from your imageRUNNER C1325 directly to a USB device without the need of a computer. You can choose to save your documents into various file formats including PDF, JPEG or TIFF.

Print your PDF\*, JPEG or TIFF documents saved in a USB device without the need of a computer. Simply plug in your USB, select your file and print!

\*Requires PS Print Kit or USB Direct Print(for PDF) to print PDF documents.

### IMAGE COMBINATION

Combine multiple pages into one single page. Save cost by printing your drafts using image combination for a final review. You can even specify the page layout and binding position with just few taps on the screen.

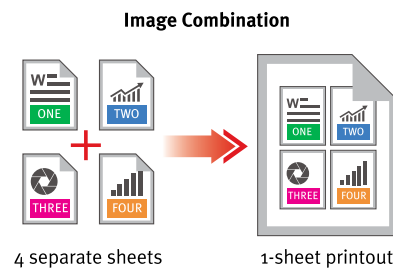



## SECURITY



### FUNCTION LEVEL LOGIN

Prevent data leakage by restricting send function to authorised users without affecting the print and copy features of the device. Administrator is able to restrict unauthorised sending in a controlled environment.

### DOCUMENT SECURITY

With the optional Send PDF Security feature, you can be assured that any information in your PDF document is secured.

**Encrypted PDF:** You can set a password and the level of security by encrypting a PDF.

**PDF with Digital Signature:** Generate a device signature key and certificate that identifies the device where a document was scanned. The certificate is appended when an original is scanned and converted into a PDF file.

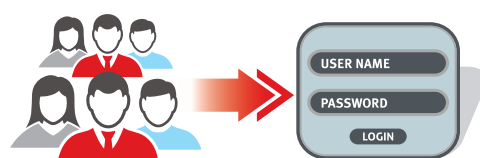

Department ID Page Total			
Page Total			
Register New Department		Clear All Counts	
Department ID	Page Total/Page Restriction	Black & White Copy	Black & White Print
0123456	750	250	500
0001	500/800	300/500	200/300
0002	650/1000	450/650	190/350
1639	360/800	250/400	210/400

### DEPARTMENT ID MANAGEMENT

Specify access privileges for different users by registering a Department ID for different workgroups or departments. When enabled, this feature requires users to login with their respective IDs and they are only allowed to access the pre-specified device features. For easy administration, usage information by each department can be retrieved at a click of a button.

### SECURE PRINT

Protect the confidentiality of your information by setting a PIN code to a document when printing from a computer. The document sent to print will be held in the memory of the device. It will only print when the user physically enters the PIN code at the device. This prevents your documents from being left unattended after printing out.

## e-MAINTENANCE

With eMaintenance, you can reduce administration burden and increase machine uptime. Now you can manage and control your Canon multifunction devices more efficiently.

### TONER ON DEMAND

When toner level are running low, eMaintenance will help place a re-order request directly with the relevant service centre. With its consumables management function to assist with order, you will never run out of toner.

### MAXIMISING UP-TIME

The system will contact relevant service centre automatically within business hours when a device fault occurs. It will continue to transmit error messages to the relevant service centre even during non-office hours, as long as the machine is connected.

## uniFLOW : PRECISION MANAGEMENT

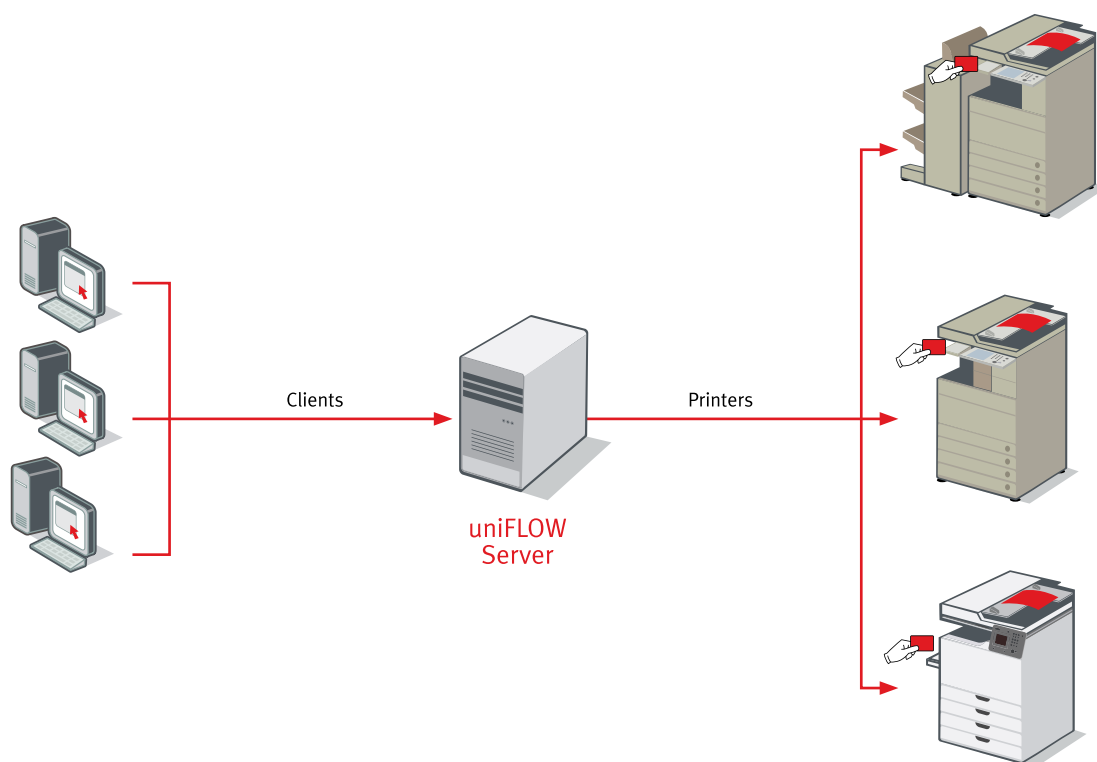

### EXACTING SECURITY AND MANAGEMENT

The imageRUNNER C1325, together with uniFLOW, allows for advanced control and precise management with features like device authentication, usage accountability and secure printing solutions.

#### PRINT MANAGEMENT

You can now track print activities on the device, and generate reports for easy viewing and analysis.

#### COST ACCOUNTING

Charge printing cost to individuals or assign the expense to respective workgroups or departments without the manual, messy accounting procedures.

#### AUTHENTICATION PRINTING

Keep documents unprinted until the user login and releases the document from the device. Users will only be able to view their own print jobs upon authentication. This means the user can securely collect confidential documents and eliminate the problem of forgotten printouts in the machine's output tray.

#### MY-PRINT-ANYWHERE

Pick up your printed document from any multi-function device connected to the uniFLOW server. Simply identify yourself at the device of your convenience!

## VALUE ADDED FAX OPERATION

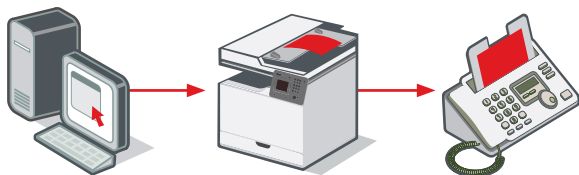

### SEND FAXES FROM PC, HASSLE-FREE

With the addition of an optional Fax Board, you can create a fax document on your computer and send it off directly without the need to print out a hardcopy. A great way to save paper and reduce costs.

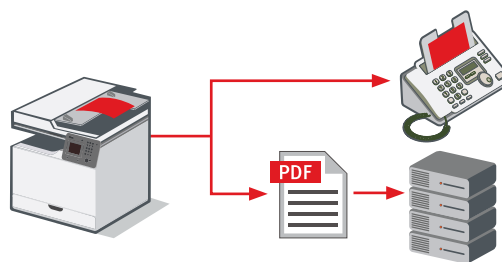

### ARCHIVING SENT FAX DOCUMENTS

You can choose to save sent faxes in a pre-set destination to an email address, shared folder or file server. In the event of a fax error, you can easily retrieve the PDF copy of the failed fax without having to search for the originals document and re-send through fax driver.

\*Fax is an optional feature.

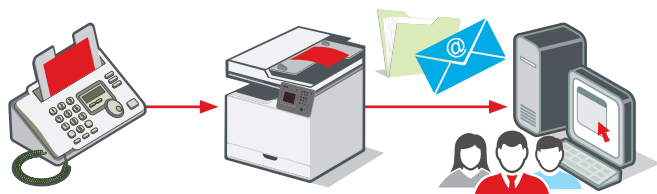

### MANAGE RECEIVED FAXES EFFICIENTLY

You can set your device to forward on faxes to an email address, shared folder or file server. All faxes will be converted into PDF format before they are directed to their respective destinations. You will never miss any receiving fax document again.

## ENVIRONMENTAL CARE

### A SMALLER ENVIRONMENT FOOTPRINT



#### REDUCE YOUR PAPER USAGE

Print on both sides of the paper for your copies, print jobs or even incoming faxes. You can also choose to shrink multiple pages onto a single sheet of paper. The combination of these two functions allow you to save even more paper when you select them simultaneously - print multiple pages on 1 page, double sided.



#### SLEEP MODE

Save energy and costs by setting your device to automatically go into Sleep Mode when it is not in use. To come out of it, simply tap the screen or press any key on the operation panel.

#### USE OF BIOPLASTICS

Bioplastics, made from organic, plant-based raw materials, are recyclable via a waste-to-energy system. It is used in the imageRUNNER C1325 in parts where the user comes into contact with the most, for instance, the control panel keys.

# SPECIFICATIONS Colour imageRUNNER C1325

Type	Colour Laser Multifunctional (Reader/Printer Separated)	
Maximum Original Size	A4	
Acceptable Originals	Sheet, book, and three dimensional objects (up to 2 kg)	
Paper Sizes	Cassette 1	A4, B5, A5, and Custom size (98.4 x 190.5 mm to 216 x 355.6 mm) and Envelopes (COM10 No.10, Monarch, DL, and ISO-C5)
	Cassette 2 to 4	A4, B5, A5, and Custom size (98.4 x 190.5 mm to 216 x 355.6 mm)
	Multi-Purpose Tray	A4, B5, A5, and Custom size (98.4 x 190.5 mm to 216 x 355.6 mm) and Envelopes (COM10 No.10, Monarch, DL, and ISO-C5)
Paper Weight	Paper Drawer	60 to 163 g/m <sup>2</sup>
	Multi-Purpose Tray	60 to 220 g/m <sup>2</sup>
Paper Capacity	Cassette 1	550 sheets (80 g/m <sup>2</sup> )
	Multi Purpose Tray	100 sheets (80 g/m <sup>2</sup> )
Resolution	Scan	300 x 300 dpi
	Copy	600 x 600 dpi
	Print	600 x 600 dpi
Copy/Print Speed	Monochrome/Colour: 25/25 ppm	
Magnification	Copy Ratio	25-400% (in 1% increment)
First Copy Time	Full Colour: 10.5 seconds Monochrome: 8.4 seconds	
Warm-Up Time	From Power On	34 seconds or less
	From Sleep Mode	10 seconds or less
Multiple Copies/Prints	1 to 999 copies	
Memory capacity	1 GB	
Interface	Network	Ethernet 10Base-T / 100Base-TX / 1000Base-T (RJ-45)
	Others	USB 2.0 x 2 (Host), USB 2.0 (Device), USB 1.1 (Host)
Power Supply	220 to 240 V AC, 50/60 Hz, 3-7A	
Max Power Consumption	Maximum Power Consumption: 1.5 kW or less When the machine is in the Sleep mode*: 1 W When the main power switch is turned OFF: 0.1 W or less * Depending on the system and conditions of use, these values may differ.	
Toner Yield (A4, 6% coverage)	Black: 16,500 Colour (Cyan, Magenta, Yellow): 11,500	
Drum Yield	Black: 37,900	
	Colour (Cyan, Magenta, Yellow): 23,600	
Dimensions (H x W x D)	610 mm x 511 mm x 549 mm	
Weight	Approximately 44 kg	
Installation Space (W x D)	852 mm x 564 mm (when the multi-purpose tray is extended)	
PRINT SPECIFICATIONS		
PDL	UFR II (Standard), PCL5c/6 (Optional), Adobe PostScript 3 (Optional)	
Resolution	600 x 600 dpi	
Supported OS	UFR II	Windows XP, Windows Vista, Windows 7, Windows 8, Windows Server 2003, Windows Server 2008, Windows Server 2008 R2, Windows Server 2012, Mac OSX (10.4.9 or later*) *OS X Yosemite is currently not supported at the time of brochure production.
	PCL (Optional)	Windows XP, Windows Vista, Windows 7, Windows 8, Windows Server 2003, Windows Server 2008, Windows Server 2008 R2, Windows Server 2012
	Adobe PostScript 3 (Optional)	Windows XP, Windows Vista, Windows 7, Windows 8, Windows Server 2003, Windows Server 2008, Windows Server 2008 R2, Windows Server 2012, Mac OSX (10.4.9 or later*) *OS X Yosemite is currently not supported at the time of brochure production.
Network Protocol	TCP/IP (LPD/Port9100/WSN/IPP/PPS/SMB/FTP), IPv6, IPX/SPX (NDS, Bindery), AirPrint	
Pull Scan	Network TWAIN Driver (75 to 600 dpi 24bit colour/ 8bit grayscale/2bit Black & White)	

SEND SPECIFICATIONS		
Scan Speed (A4, 300 dpi)	Black & White / Colour: 51 ipm	
Scan Resolution	300 x 300 dpi	
Destinations	Email (SMTP), PC Network Folders (SMB, FTP)	
Standard File Format	PDF	PDF, Searchable PDF, Compact PDF, Compact & Searchable PDF
	Others	TIFF, JPEG
Optional File Format (Send PDF Security Feature Set-E1)	PDF	Device Signature PDF, User Signature PDF
AUTOMATIC DOCUMENT FEEDER		
Size of Originals	A4, B5, A5 and B6	
Original Paper Weights	One-sided originals*	50 to 105 g/m <sup>2</sup>
	Two-sided originals	64 to 105 g/m <sup>2</sup>
	* When scanning only one sheet of paper, originals from 50 to 128 g/m <sup>2</sup> are supported.	
Tray Capacity	50 sheets (80 g/m <sup>2</sup> )	
Original Scanning Speed	Copying: 1-sided scanning: 15 sheets/minute (A4 in Black-and-White/ Full Colour at 300 x 600 dpi)	
	Scanning: 1-sided scanning: 25 sheets/minute (A4 in Black-and-White/ Full Colour at 300 x 300 dpi)	
OPTIONAL ACCESSORIES		
CASSETTE FEEDING UNIT-AJ1		
Paper Sizes	A4, B5, A5, and Custom size 98.4 x 190.5 mm to 216 x 355.6 mm	
Paper Capacity	550 sheets (80 g/m <sup>2</sup> ) x 1	
Power Source	From the main unit	
Power Consumption	Approximately 25 W	
Dimensions (H x W x D)	425 x 511 x 508 mm	
Weight	Approximately 15 kg	
CASSETTE FEEDING UNIT-AK1		
Paper Sizes	A4, B5, A5, and Custom size (98.4 x 190.5 mm to 216 x 355.6 mm)	
Paper Capacity	550 sheets (80 g/m <sup>2</sup> ) x 3	
Power Source	From the main unit	
Power Consumption	Approximately 35 W	
Dimensions (H x W x D)	425 x 511 x 508 mm	
Weight	Approximately 19 kg	
OTHER ACCESSORIES AND SUPPLIES		
Copy Card Reader-F1, Card Reader Attachment-H1, Super G3 FAX Board, Cassette Heater Unit-39, FL Cassette-AV1, Copy Control Interface Kit-A1, ADF Access Handle-A1, PCL Printer Kit-AZ1, PS Printer Kit-AZ1, Barcode Printing Kit-D1, USB Direct Print (PDF)-K1, , NPG-65 Drum Unit K/C/M/Y, NPG-66 Toner K/C/M/Y		

This brochure and the specifications of the product have been developed prior to the date of product launch. These specifications are subject to change without notice. Therefore no representations or warranties, either express or implied, are made of the fitness of this product for a particular purpose. In no circumstances shall the information in this brochure be considered part of our terms and conditions of sale. You are advised to check the prevailing specification immediately prior to purchase. All company and/or product names are trademarks and/or registered trademarks of their respective manufacturers in their markets and/or countries.



## SOUTH & SOUTHEAST ASIA REGIONAL HEADQUARTERS

CANON SINGAPORE PTE. LTD.  
1 Harbourfront Avenue #04-01, Keppel Bay Tower, Singapore 098632  
Tel: +65-6799 8888 Fax: +65-6799 8882  
www.canon-asia.com

## CANON SALES SUBSIDIARIES & BUSINESS PARTNERS

### Afghanistan

Megaplus Afghanistan Limited  
House No. 233, Street No. 4, Charagh Ali,  
Qilla-e-Fatehullah, Kabul, Afghanistan  
Tel: +93-700-228-832 / +93-700-979-511  
Fax: +93-202-201-259  
info@megaplus.com.af

### Bangladesh

Flora Limited  
Adamjee Court Annex-2, (4th Floor)  
119-120 Motijheel Commercial Area  
Dhaka-1000, Bangladesh  
Tel: +880-2-716-2742 to 46  
Fax: +880-2-955-0030  
www.floralimited.com

### Brunei

Interhouse Company  
No. 5-7, Bunut Jaya Complex  
Spg. 574, Kim 7 1/4, Jalan Tutong BF1320  
P.O. Box 423, Seri Complex  
Bandar Seri Begawan BA1779  
Negara Brunei Darussalam  
Tel: +673-2-653-001  
Fax: +673-2-653-003

### Cambodia

Royal Cambodia Co., Ltd  
#437 Preah Monivong Blvd.  
Phnom Penh, Cambodia  
Tel: +855-23-428-955  
Fax: +855-23-722-961

### India

Canon India Pvt. Ltd.  
7th & 8th Floor,  
Tower B Building # 5  
DLF Epitome, DLF Phase III  
Gurgaon - 122002  
Tel: +91-124-416 0000  
Fax: +91-124-416 0011  
www.canon.co.in

### Indonesia

PT Samafitro  
Jl. Ir. H. Juanda No. 8  
Jakarta 10120, Indonesia  
Tel: +62-21-345-8989  
Fax: +62-21-345-6699  
www.samafitro.co.id

### Malaysia

Canon Marketing (Malaysia) Sdn Bhd  
Block D, Peremba Square,  
Saujana Resort, Section U2,  
40150 Shah Alam,  
Selangor Darul Ehsan, Malaysia  
Tel: +60-3-7844 6000 / +60-3-7845 0055  
Fax: +60-3-7844 6196 / +60-3-7844 6198  
www.canon.com.my

### Maldives

SIMDI Company Pvt Ltd.  
Head Office: G. Manaam Building,  
2/1 Neeloafaru Road,  
Male' 20-129, Maldives  
Tel: +960-333-4421  
Fax: +960-333-4424

### Myanmar

Myanmar Golden Rock International  
Co., Ltd  
No. 79-D, Bo Chein Street, Pyay Road,  
6 1/2 Mile, Hlaing Township,  
Yangon, Myanmar  
Main Tel: (01) 654810 to 654819 (10 Lines)  
(01) 654844 to 654848 (5 Lines)  
Fax: (01) 654820

### Nepal

International Electronics Concern  
Pvt. Ltd.  
Kha 14 1st Floor, Haratibhawan  
Patalisadak,  
Ramshah Path, Kathmandu, Nepal  
P.O. Box 12588  
Tel: +977-1-442-1991  
Fax: +977-1-442-1909

### Pakistan

Shirazi Trading Company (Pvt.) Ltd  
8th Floor, Adamjee House,  
I.I. Chundrigar Road,  
Karachi 74000 Pakistan  
Tel: +92-21-3241 7659 / 7737 / 7746  
Fax: +92-21-3241 7747 / 3242 0417  
www.shirazitrading.com.pk

### Sri Lanka

Metropolitan Office (Pvt) Ltd  
12, Magazine Road,  
Colombo 08, Sri Lanka  
Tel: +94-11-470 0200  
Fax: +94-11-470-0267  
http://www.metropolitan.lk/

### Thailand

Canon Marketing (Thailand) Co.,  
Ltd.  
No.98 Sathorn Square Office Tower,  
21st -24th floor,  
North Sathorn Road, Silom, Bangrak,  
Bangkok 10500  
Tel: +66-2-344-9999  
Fax: +66-2-344-9960  
www.canon.co.th

### Vietnam

Canon Marketing (Vietnam) Co. Ltd  
Level 10, President Place  
93 Nguyen Du, Dist 1, Ho Chi Minh City,  
Vietnam  
Tel: +84-8-38200 466  
Fax: +84-8-38200 477  
www.canon.com.vn

This document is for information purpose only and the contents are subject to change without notice. Product options, name and availability may vary by regions. Nothing in this document should be construed as a warranty. We expressly disclaim any liability or contractual obligations with respect to this document.

Canon, imageRUNNER, imageRUNNER ADVANCE, imageCHIP, RAPID Fusing System, MEAP, eMaintenance, iW, Business can be simple and get Smart get genuine are trademarks of Canon Inc. and/or its affiliates. "MEAP" is a trademark of CANON Inc., referring to an "application platform" for Canon, multifunction and single function printers. Other names may be the trademarks of their respective owners. uniFLOW, eCopy and Therefore are independent party software distributed by Canon Singapore Pte Ltd.

Dealer's Stamp